



# KASTA

## Curtain Control Module

**KASTA-C300IBH**

## Bluetooth Curtain Control Module

Smart Curtain Control Module that's installed behind a standard wall plate with momentary mechanisms providing open/up, stop and close/down control of devices such as a motorised curtain or blind. It can be manually operated, controlled by KASTA remote switch devices or controlled via the KASTA app. Use the app to configure the module, including automation functions.

### Applications

Residential dwellings, Apartments, Commercial, Retail, Hospitality, Accommodation, New construction, Retrofit & Renovation

### Accessories

Download the KASTA app

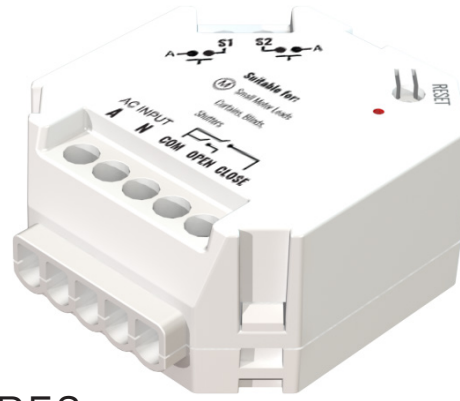

## FEATURES

- Control AC powered motors (4-wire switched motor) or DC powered motors (Class I or Class II)
- Load (max.) 300W
- 7 wire connection for power, motor and momentary switch mechanisms
- Short Press on input S1 or S2 to fully Open or Close, a second Short Press to stop/pause
- Long Press (S1, S2) >2s will initiate movement until released
- Wireless Bluetooth Mesh communication
- Pair with KASTA remote switch devices for wireless control (8x maximum)
- Configured and controlled using the KASTA app (iOS and Android)
- Supports Group, Scene, Timer and Scheduling automation functions
- Built in overvoltage protection
- Maximum 30 second run time (when not calibrated) to protect motor
- Suits all Australian wall plates using a momentary mechanism
- 3 year warranty

## ELECTRICAL

Power Supply	220-240VAC 50Hz
Physical Connection Type	Terminals
Wiring Connections	Active, Neutral, Motor (Open/Close), Momentary Mechanisms
Load Output (Inductive) Max.	300W (1.2A)
Load Compatibility	AC Motor: Standard bidirectional 4-wire 240VAC single phase motor with internal limit switches (2 Active, 1 Neutral, 1 Earth) DC Motor: Class I or Class II equipment only, up to 24VDC (max.) with internal limit switches
Form Factor	Module (puck)
Housing Material	Polycarbonate (PC)
Dimensions (WxDxH)	47mm x 52mm x 22.5mm
IP Rating	IP20
Operating Ambient Temp.	-20 to 40°C
Standards Complied	AS/NZS 60669.2.1 AS/NZS 60669.1 AS/NZS 60950.1 AS/NZS CISPR 15 AS/NZS 4268

### CONNECTION DIAGRAM

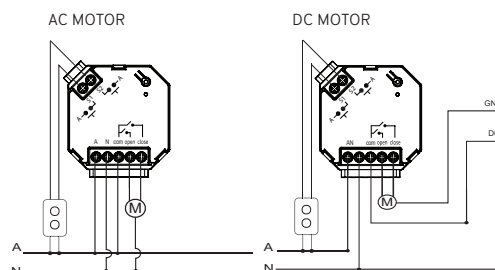

### DIMENSIONS

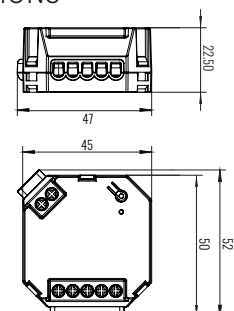

Specification subject to change without prior notice. Last updated 22/07/2020

[kasta.com.au](http://kasta.com.au)